

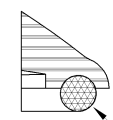

Data	No. CI LAN	Ver	Modification	Request	E	Drawer
500000068249	27/04/2011		DIM. 27 ERA 31.		I	LEONELTE

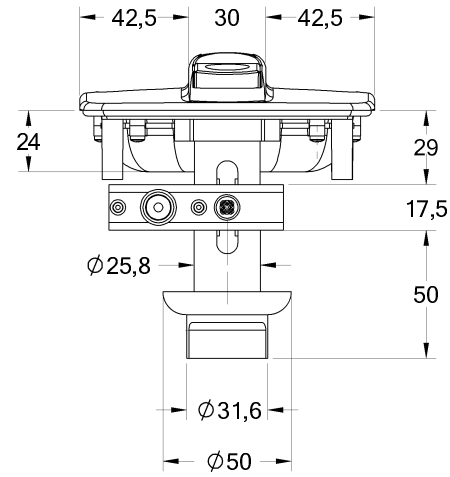
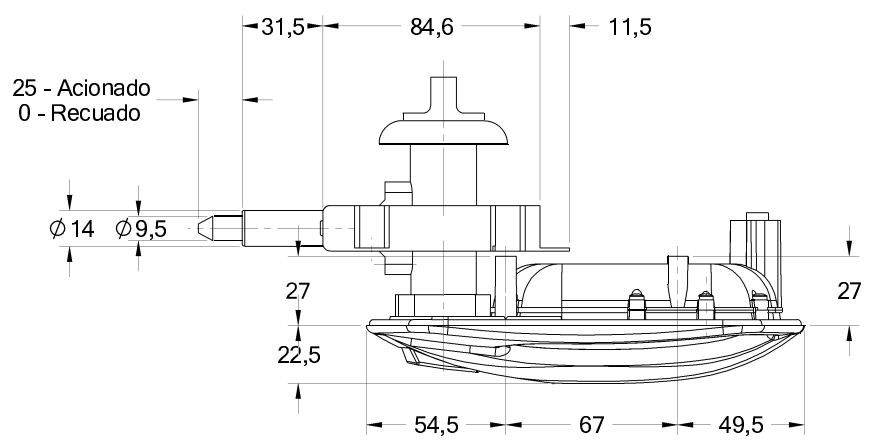
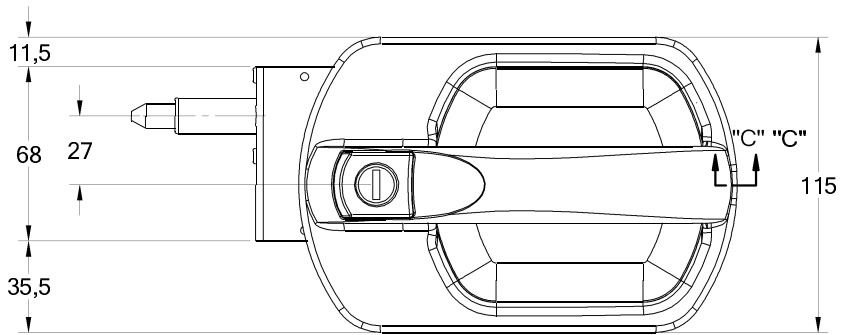
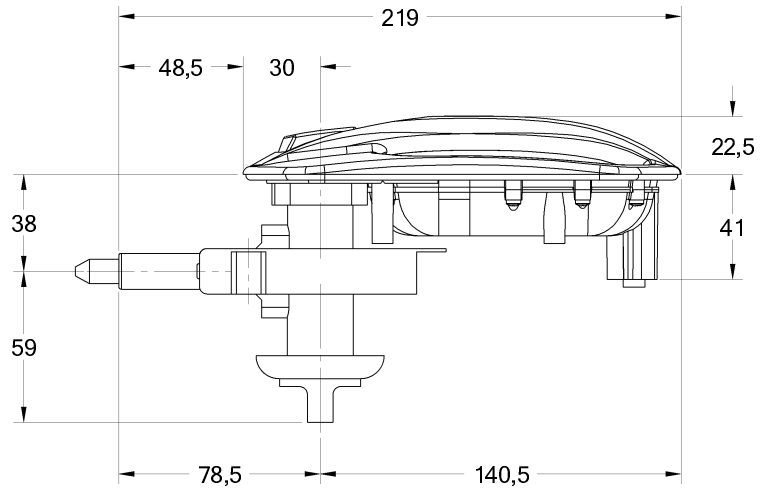

SECCAO "CC"
"CC" SECTION
Scale 1:1

APLICAR PU PARA VEDAÇÃO
APPLY PU TO SEALING

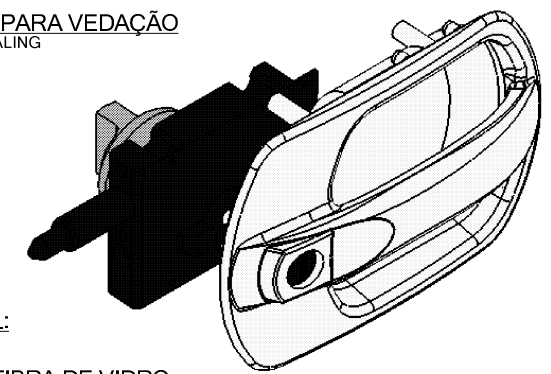

MATERIAL CORPO PRINCIPAL:
PRINCIPAL BODY MATERIAL:
POLIAMIDA 6.0 COM 30% DE FIBRA DE VIDRO
POLYAMID 6.0 WITH 30% FIBERGLASS

COR PRETO C/ TEXTURA 1
BLACK COLOR WITH TEXTURE 1

* **PEÇAS METALICAS TRATAR C/ ZINCADO AMARELO (Fe Zn 12C2)**
METALIC PARTS TREATMENT WITH YELLOW ZINC (Fe Zn 12C2)

Tolerâncias quando não especificadas
base conforme DIN ISO 2768-1 classe m = médio

When not otherwise specified, dimensions shall be in accordance with DIN ISO 2768-1 m = medium

Dimensões Dimensional	0,5 - 3 0,1	3 - 6 0,1	6 - 30 0,2	30 - 120 0,3	120 - 400 0,5	400 - 1000 0,8	1000 - 2000 1,2	2000 - 4000 2
Chamada Callout	± 0,2	± 0,1	± 0,2	± 0,3	± 0,5	± 0,8	± 1,2	± 2
Raio Radius	± 0,2	± 0,5	± 1	± 1	± 1	± 0,20	± 0,10	± 0,5

ITEM	CODE	QTY
------	------	-----

 Marcopolo Caxias do Sul - RS BRAZIL	Scale: 1:2,5	Date: 27/4/2011	Denomination: MACANETA EXTERNA EXTERNAL HANDLE MANILLA EXTERNA
	Liquid weight(Kg): 0,261	Origin:	
	Version:	AD	
Drawer: LEONELTE Reviser: LEONELTE Approved: LEONELTE	Use: PORTA DE SERVIÇO LD.		Code: 10047136
			Class: 172456